

POWERLOK® II™ SCREWS

ALL-METAL LOCKING FASTENERS

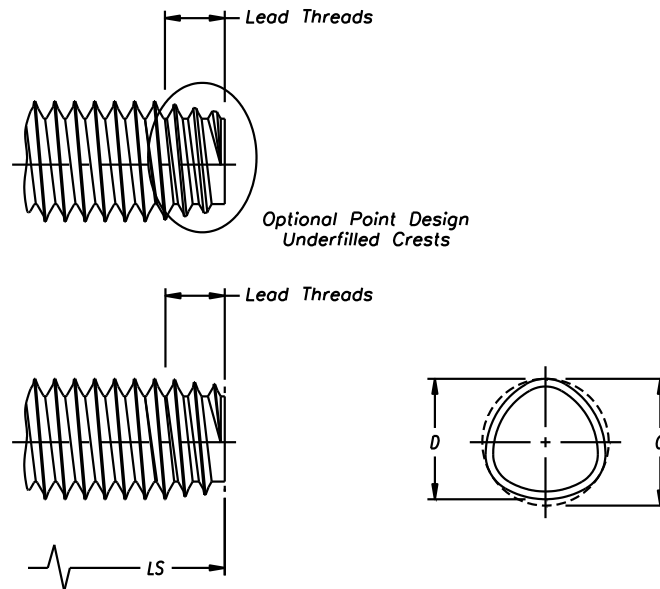

POWERLOK® II™ Fastener Geometry

Thread Profile:

The innovative Dual-Angle™ thread form provides "live-action" locking.

The deflection of the thread tip creates classic "stored energy" locking.

Interferes in the root of the nut thread. Locking is not affected by an incomplete internal thread form.

TRILOBULAR® Body:

Capitalizes on elastic memory of nut member.

Further prevents vibrational loosening by providing additional locking action.

Reduces friction during installation.



Spring action of the Dual-Angle™ Thread Profile

POWERLOK® II™ Fastener Advantages

- No need for patches, adhesives or assembly line applied locking compounds.
- Locking action is over the entire length of the screw thread.
- Locking action is not affected by temperature.
- No adhesive curing time—instantaneous locking action.
- No need for under head locking elements.
- No need for costly lock washers.
- Works with all finishes.
- Easily hand started.



POWERLOK® II™ SCREWS

ALL-METAL LOCKING FASTENERS

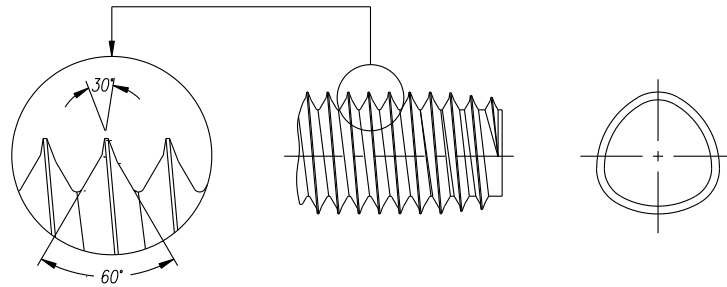

Inch Series

Screw Size	LIMITS	Screw Body	
		C	D
4-40	MAX	0.1170	0.1145
	MIN	0.1120	0.1095
5-40	MAX	0.1310	0.1285
	MIN	0.1250	0.1225
6-32	MAX	0.1470	0.1439
	MIN	0.1410	0.1379
8-32	MAX	0.1725	0.1694
	MIN	0.1665	0.1634
10-24	MAX	0.2050	0.2008
	MIN	0.1980	0.1938
10-32	MAX	0.1995	0.1964
	MIN	0.1925	0.1894
12-24	MAX	0.2310	0.2268
	MIN	0.2240	0.2198
1/4-20	MAX	0.2695	0.2645
	MIN	0.2615	0.2565
1/4-28	MAX	0.2625	0.2589
	MIN	0.2545	0.2509
5/16-18	MAX	0.3315	0.3259
	MIN	0.3235	0.3179
3/8-16	MAX	0.3945	0.3883
	MIN	0.3865	0.3803
7/16-14	MAX	0.4595	0.4524
	MIN	0.4515	0.4444
1/2-13	MAX	0.5235	0.5158
	MIN	0.5155	0.5078

Metric Series

SCREW SIZE	LIMITS	BODY	
		C	D
M2.0 x 0.40	MAX	2.15	2.11
	MIN	2.05	2.01
M2.5 x 0.45	MAX	2.66	2.62
	MIN	2.56	2.52
M3.0 x 0.50	MAX	3.18	3.13
	MIN	3.08	3.03
M3.5 x 0.60	MAX	3.69	3.63
	MIN	3.59	3.53
M4.0 x 0.70	MAX	4.22	4.15
	MIN	4.10	4.03
M5.0 x 0.80	MAX	5.26	5.18
	MIN	5.13	5.05
M6.0 x 1.00	MAX	6.30	6.20
	MIN	6.15	6.05
M8 x 1.25	MAX	8.35	8.23
	MIN	8.20	8.08
M10 x 1.50	MAX	10.40	10.25
	MIN	10.25	10.10
M12 x 1.75	MAX	12.45	12.28
	MIN	12.30	12.13

Length Tolerance - Inch - Per ANSI B18.6.3

Nominal Screw Length	Nominal Screw Size	
	#4 - #12	1/4" - 1/2"
	Tolerance On Length	
To 1/2" Inclusive	+0, - .020	+0, - .030
Over 1/2" to 1" Inclusive	+0, - .030	+0, - .030
Over 1" to 2" Inclusive	+0, - .060	+0, - .060
Over 2"	+0, - .090	+0, - .090

Length Tolerance - Metric - Per ANSI B18.6.7M

Nominal Screw Length	Tolerance on Length
	mm
To 3mm included	± 0.2
Over 3 to 10mm	± 0.3
Over 10 to 16mm	± 0.4
Over 16 to 50mm	± 0.5
Over 50mm	± 1.0

POWERLOK® II™ SCREWS

ALL-METAL LOCKING FASTENERS



KLEERLOK® Thread Clearing Lock Screw

The KLEERLOK® feature is designed to be used in conjunction with TRILOBULAR™ fasteners in pre-tapped holes which may be contaminated with weld splatter, paint, primer or other foreign matter.

The KLEERLOK® feature can be combined on a POWERLOK® screw for paint clearing and locking torque or on a reduced diameter TAPTITE® screw as a version for joints where classical torque-tension fastening rather than a locking screw is desired.

KLEERLOK® Point Form

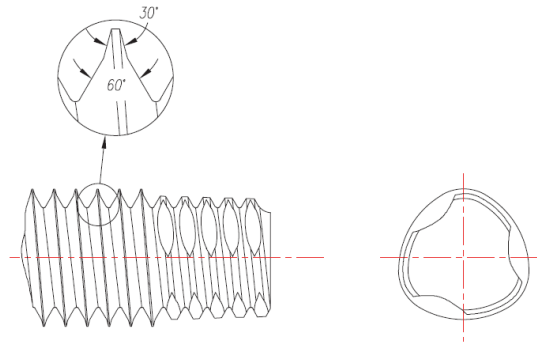

POWERLOK II®, POWERLOK®, KLEERLOK®, TAPTITE® and TRILOBULAR® are trademarks licensed by Research Engineering & Manufacturing Inc. (REMINC)



900 North Church Road
Elmhurst, IL 60126

Toll Free: (800) 323-1736

Phone: (630) 833-2880

www.semblex.com

Email: sales@semblex.com